

— = existing ground level  
— = finished height

**Existing mound 1**

Finished height (AGL): ~2.6 m, max. 3.2 m

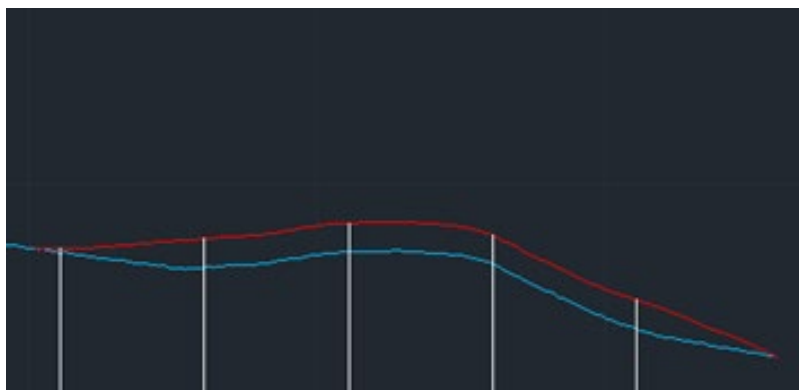

**Existing mound 2**

Finished height (AGL): ~2.85 m, max. 3.45 m

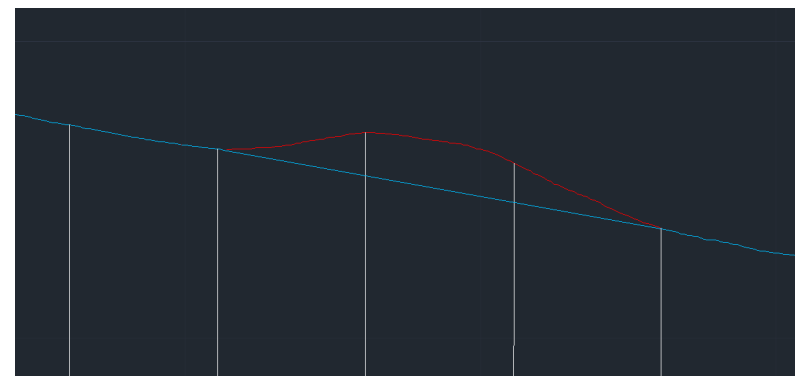

**New earth mounds**

Finished height (AGL): ~1.5 m, max 2.1 m



## **Cruiser Terrain Park Upgrades** Earth mound cross-sections

Date: 23/04/2024  
 Revision: 1  
 Kosciuszko Thredbo Pty Ltd  
 Not to scale

Trench Dimensions		
Location	Dimension	Size (mm)
A	Trench Depth	800
B	Trench Width	600

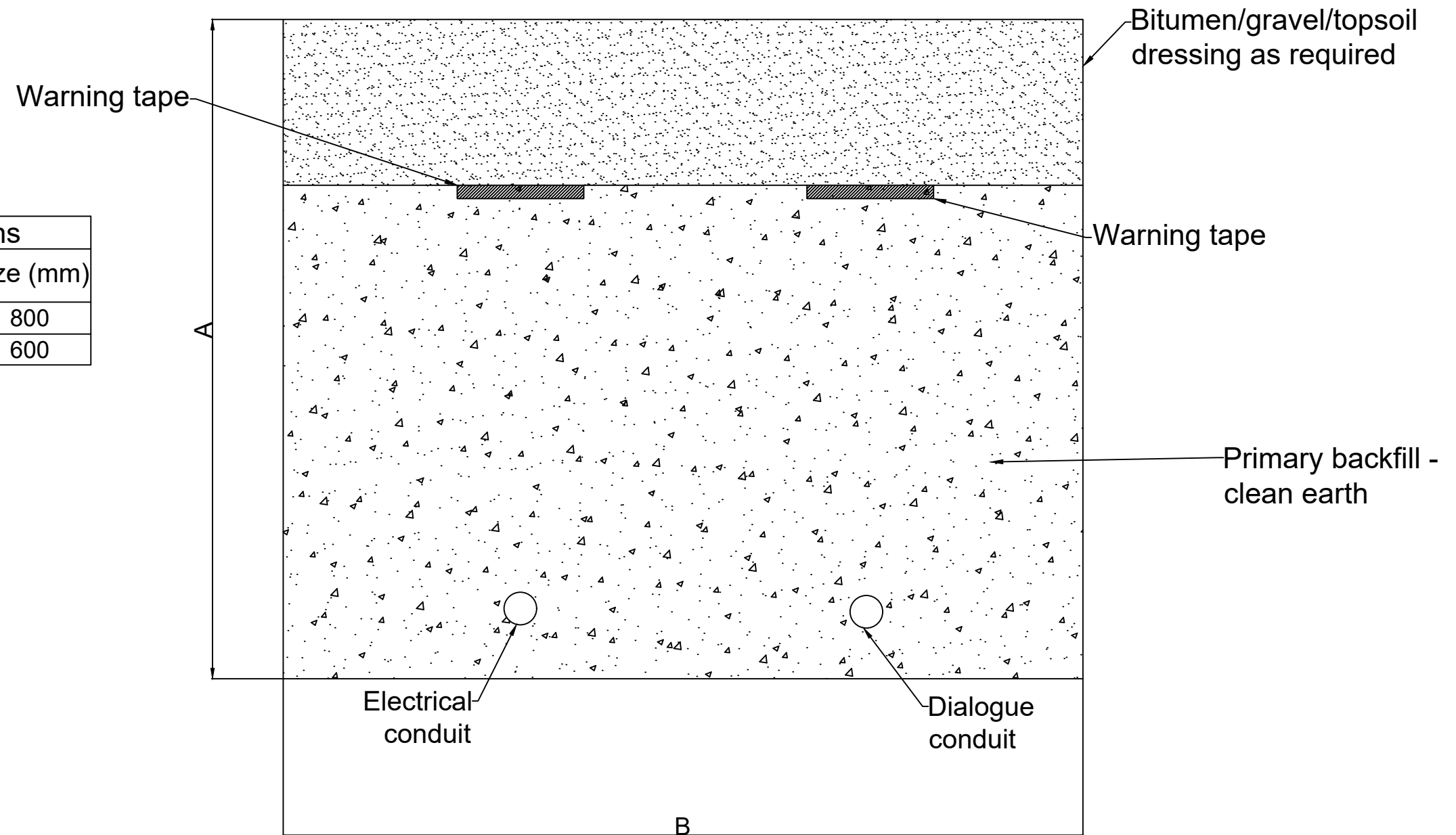

#### NOTES

- Services Separation Distances within trench, trench depth and trench width as per AS 3000 - Electrical Installations and AS 3500 - Plumbing and Drainage
- Electrical marker tape will be installed above electrical and communications services as per AS 3000

#### DRAWING

#### Snowmaking Trench Cross Section - Power and dialog

#### PROJECT

Snowmaking Fan Guns -  
Cruiser Terrain Park Upgrades



REV	DATE	DESCRIPTION
1	06/07/23	Original for DA
DESIGNED BY K. O'Sullivan		CHECKED BY R. Nuridin
SCALE NTS		FILE NAME Snowmaking Trench Cross Section.dwg
SHEET 1/1		

## Sez. A-A

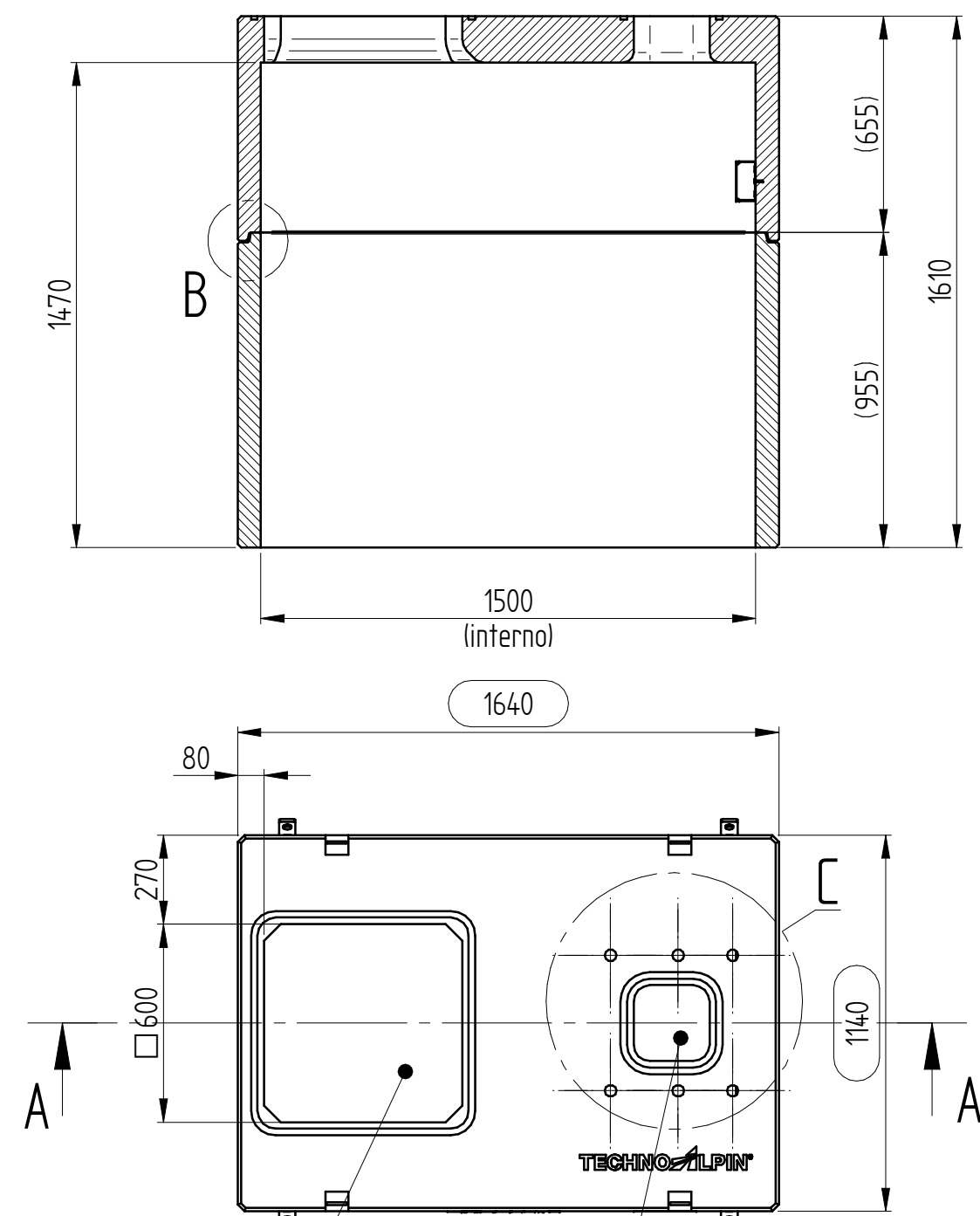

Einstiegs Luke  
Chiusino  
Entrance  
Capot de regard

Lift 4.5m / Lanze / Turm 1.6m  
Lift 4.5m / Lancia / Torre 1.6m  
Lift 4.5m / Lance / Tower 1.6m  
Lift 4.5m / Lance / Tour 1.6m

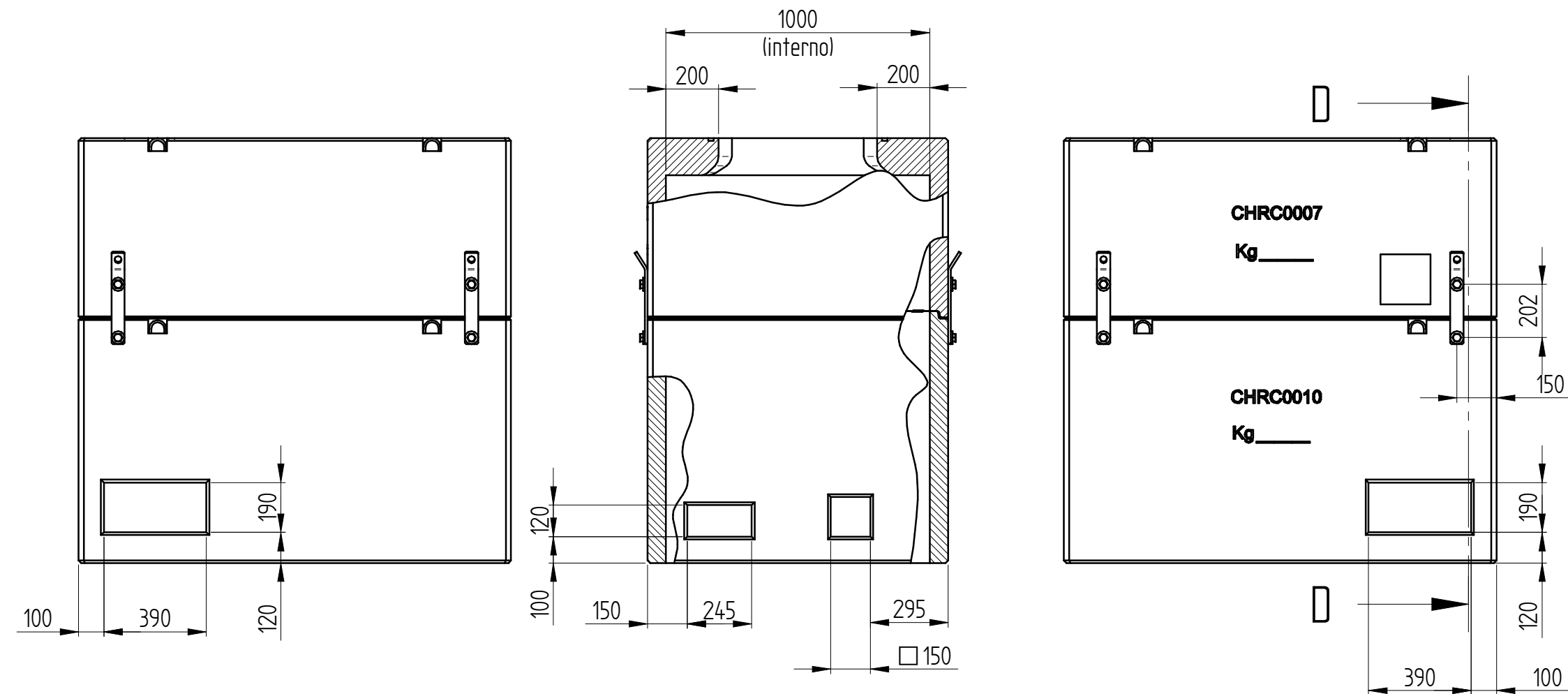

## Sez. D-D

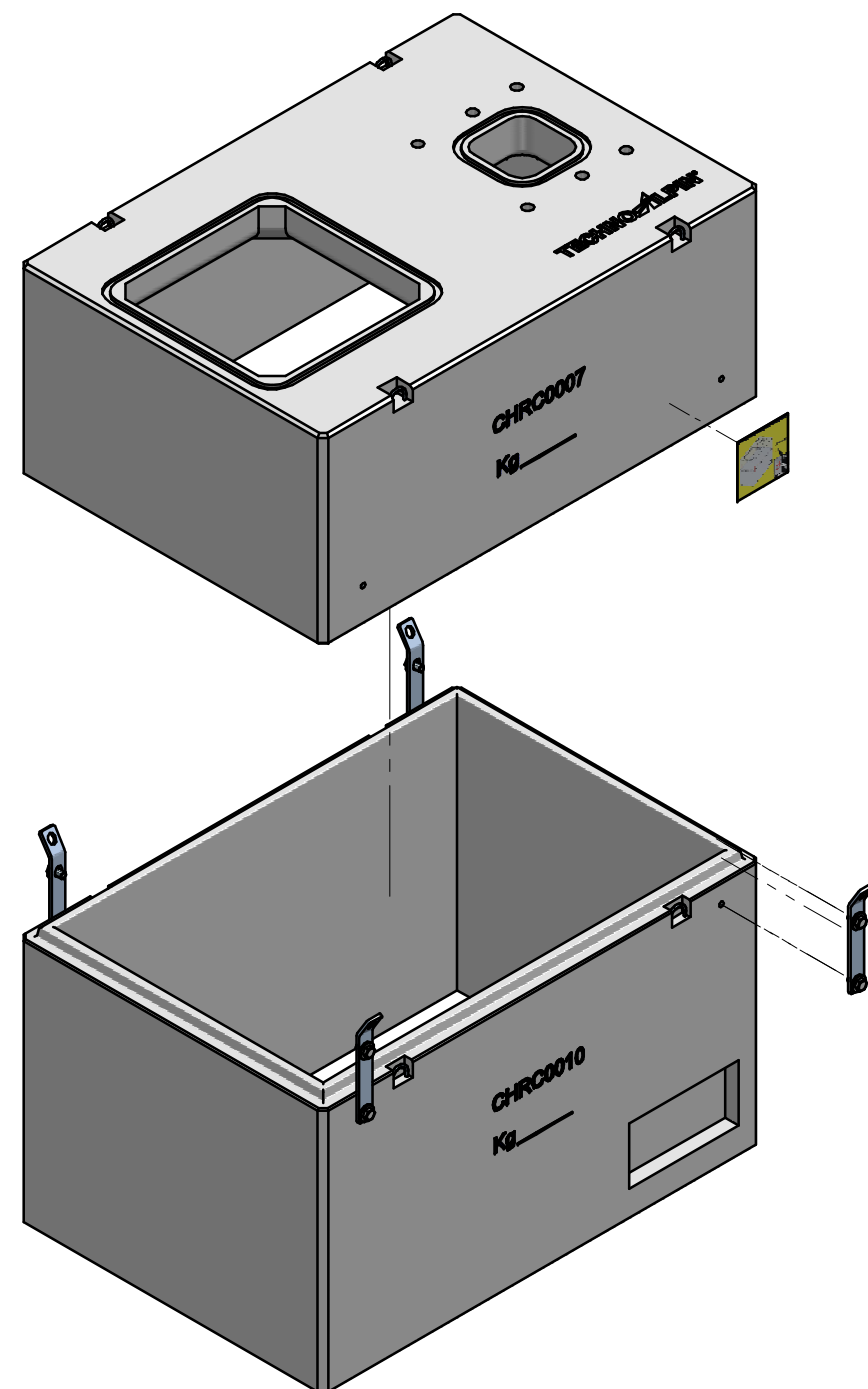
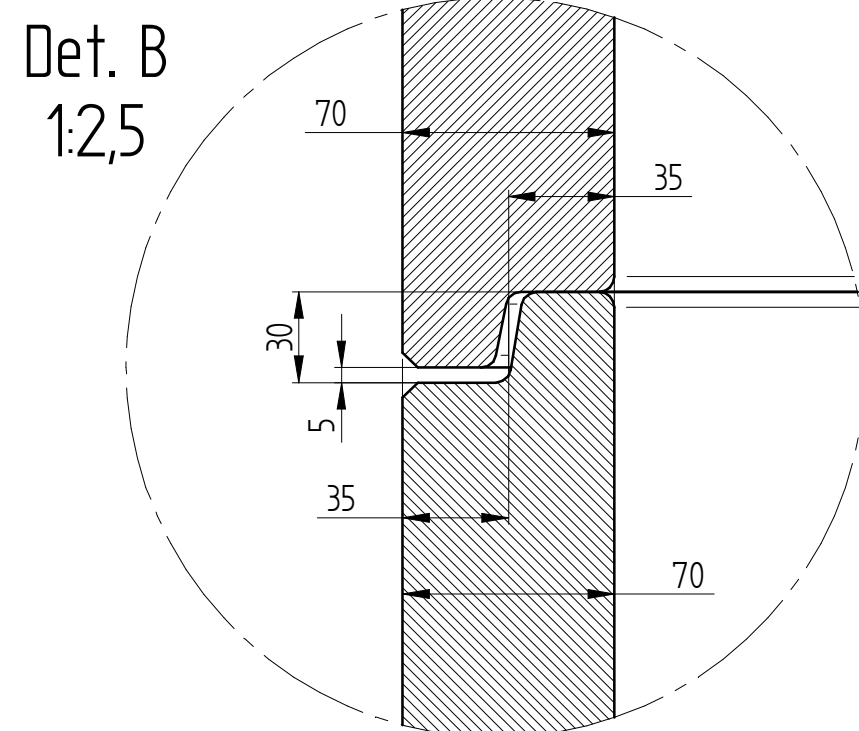
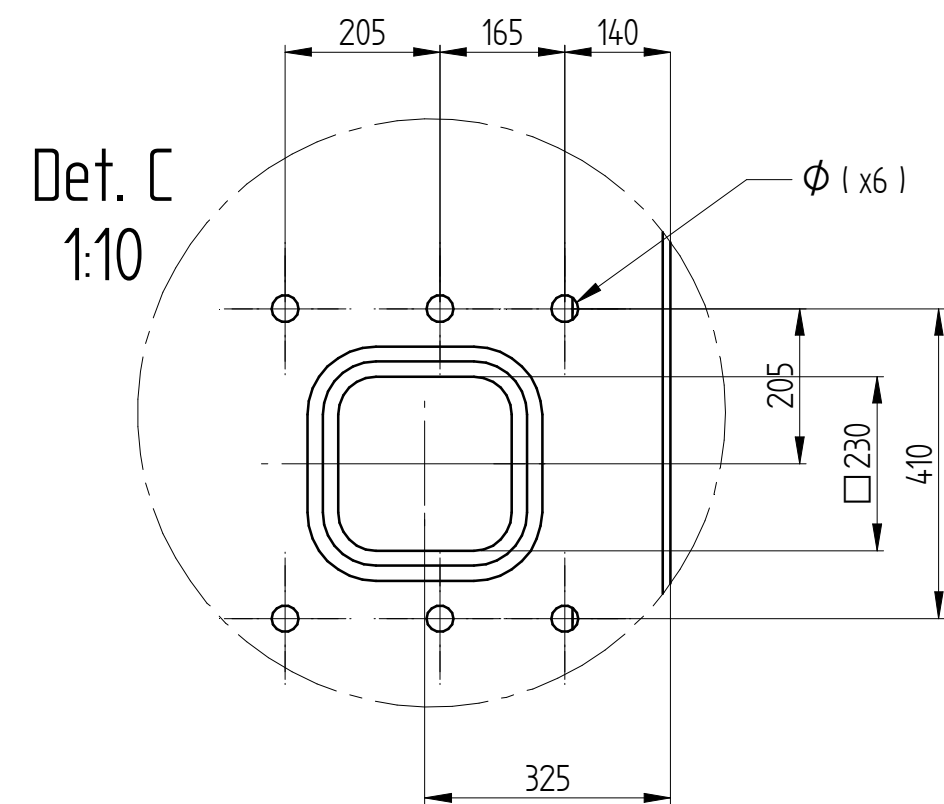

smooth surface treatment

7	SR005040	00	Plug PVC 5mm with screw TGS 5 4,0x30	5
6	BS05016	00	Washer M5x15 ZN UNI 6593	5
5	SKEE1348	00	Wiring channel T1-N 120x60 grey RAL7030	10
4	POSK0002	01	Sticker Pit indication for mounting	1
3	CHRC0012	00	Kit flange for pit complete	1
2	CHRC0007	01	Pit lid 2 entrances (reinforced) 600x600 H	1
1	CHRC0010	02	Pit lower part reinforced H	1
Pos.	Item	Rev.	Item description	Qty

[illegible]

Trench Dimensions		
Location	Dimension	Size (mm)
A	Trench Depth	1200
B	Trench Width	100
C	Water Pipe Diameter	50

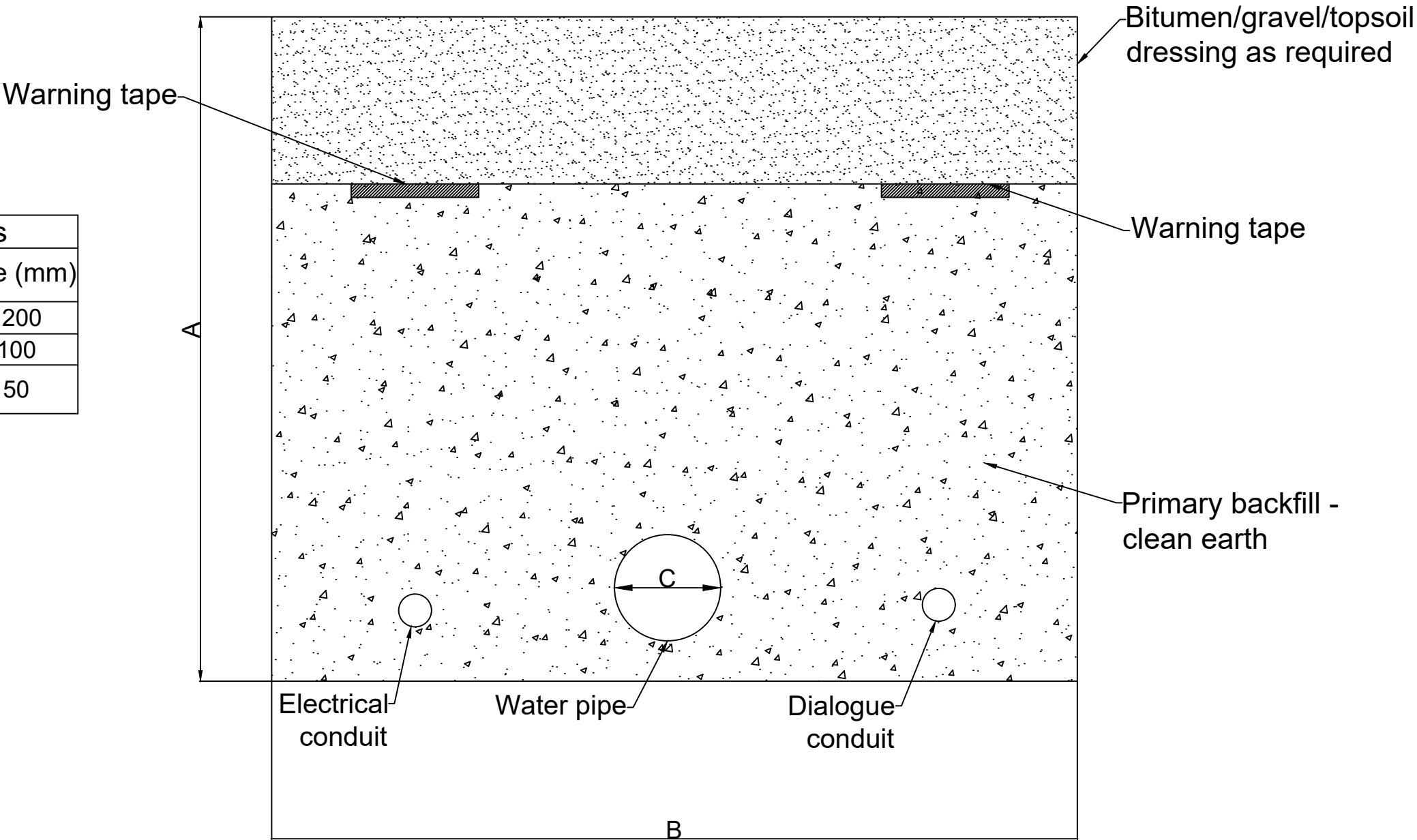

- NOTES**
- Services Separation Distances within trench, trench depth and trench width as per AS 3000 - Electrical Installations and AS 3500 - Plumbing and Drainage
  - Electrical marker tape will be installed above electrical and communications services as per AS 3000

DRAWING

Snowmaking Lateral Trench Cross Section to Fan Pit

PROJECT

Snowmaking Fan Guns - Cruiser Terrain Park Upgrades



REV	DATE	DESCRIPTION	
1	17/04/24	Original for DA	
DESIGNED BY K. O'Sullivan		CHECKED BY R. Nuridin	
SCALE NTS		FILE NAME	
SHEET 1/1		Snowmaking Trench Cross Section.dwg	

## TT10 Fan Gun Dimensions

# TT10

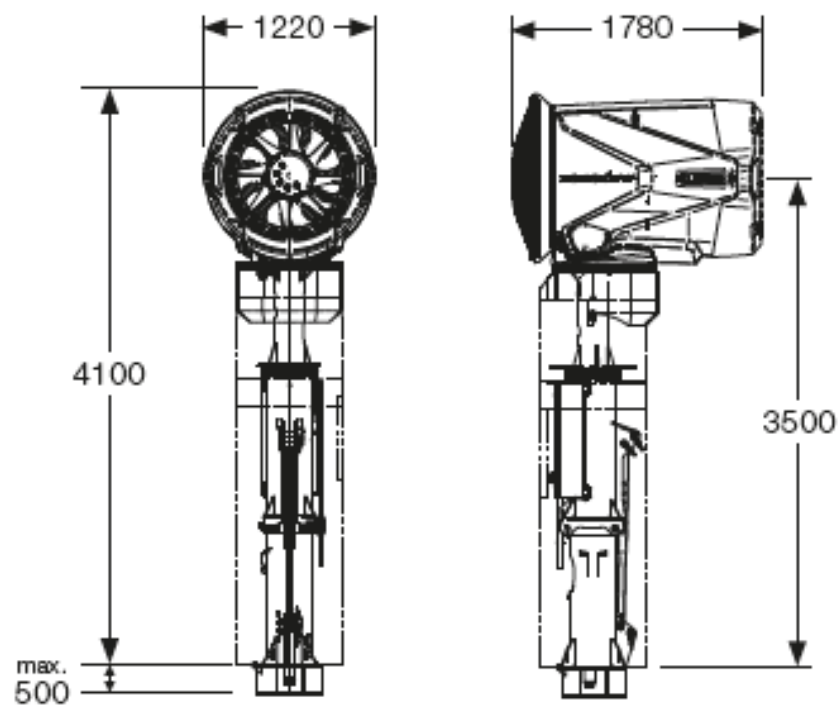

(Source: TechnoAlpin 2020)